

»G« Series

GF 11–GF 55 A

Symbol

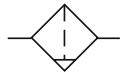

Product features

Centrifugal separators with a sintered filter element.

Specifications / Technical data

Art. No.	Size 300			Size 400		Size 600	
	GF 11, GF 11 A	GF 12, GF 12 A	GF 13, GF 13 A	GF 32, GF 32 A	GF 33, GF 33 A	GF 34, GF 34 A	GF 55, GF 55 A
Fluid	Air						
Port size	1/4"	3/8"	1/2"	3/8"	1/2"	3/4"	1"
Filtering grade	5 µm (40 µm on request)						
Pressure range	1.5 to 9 bar (0.15 to 0.9 MPa, 20 to 130 psi)						
Proof pressure	15 bar (1.5 MPa, 215 psi)						
Temperature range	-20 to 70 °C						
Capacity of drain bowl	40 cm ³			80 cm ³		230 cm ³	
Weight	360 g			680 g		1440 g	

Ordering information

Art. No.	Type
GF 11–GF 13, GF 32, GF 33	Filters with polycarbonate bowl, bowl guard and »HW« mounting bracket, semi-automatic drain valve
GF 34, GF 35	Filters with metal bowl, sight glass and »HW« mounting bracket, semi-automatic drain valve
GF 11 A–GF 13 A, GF 32 A, GF 33 A	Filters with polycarbonate bowl, bowl guard and »HW« mounting bracket, fully-automatic drain valve
GF 34 A, GF 35 A	Filters with metal bowl, sight glass and »HW« mounting bracket, fully-automatic drain valve

»G« Series

GF 11–GF 55 A

Flow chart

GF 12*, GF 13, GF 12 A, GF 13 A

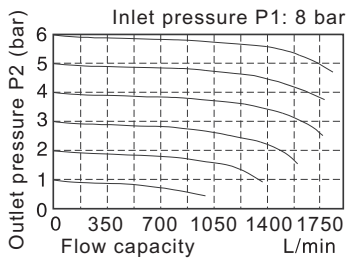

GF 32, GF 33, GF 32 A, GF 33 A

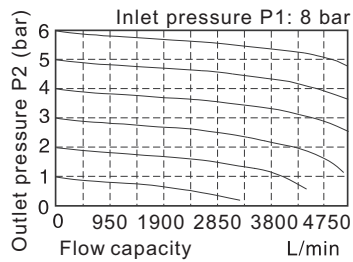

GF 34, GF 55, GF 34 A, GF 55 A

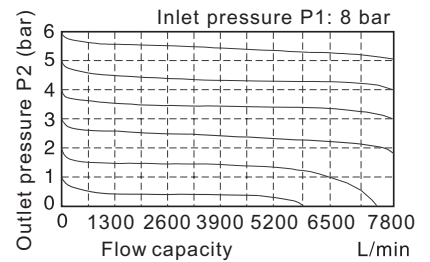

*Flow rates GF 11, GF 11 A approx. 14% less

Body dimensions

GF 11–GF 33, GF 11 A–GF 33 A

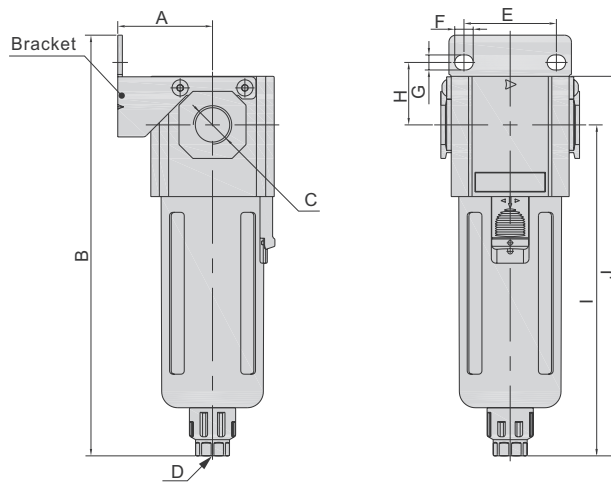

Art. No.	A	B	C	D	E	F	G	H	I	J
GF 11, GF 11 A	41	182	1/4"	G1/8	40	8	6.5	27	143	164
GF 12, GF 12 A	41	182	3/8"	G1/8	40	8	6.5	27	143	164
GF 13, GF 13 A	41	182	1/2"	G1/8	40	8	6.5	27	143	164
GF 32, GF 32 A	50	208	3/8"	G1/4	55	11	8.6	33.5	166.5	191.5
GF 33, GF 33 A	50	208	1/2"	G1/4	55	11	8.6	33.5	166.5	191.5

(Values in mm, exception C = inch)

»G« Series

GF 11–GF 55 A

Body dimensions

GF 34–GF 55, GF 34 A–GF 55 A

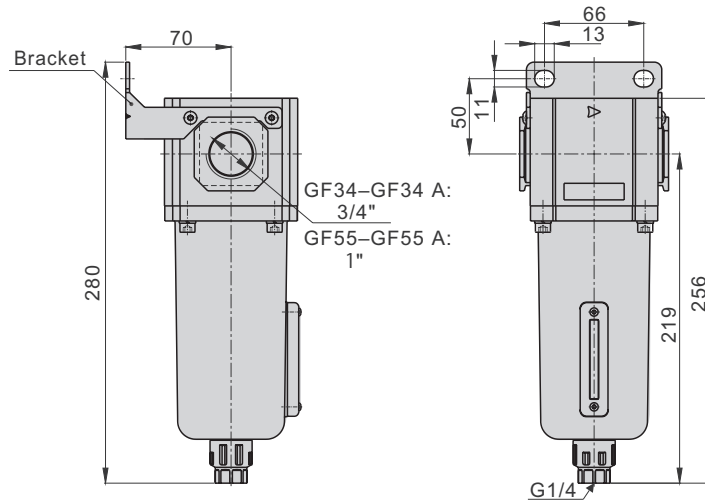

Components and materials

GF 11–GF 55 A

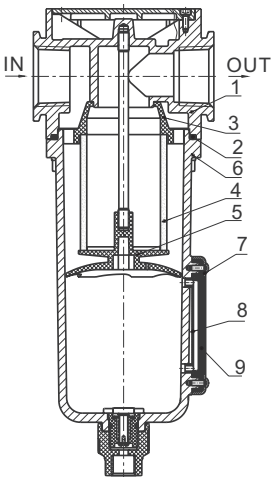









Semi-auto drain

No.	Item	Material
1	Body	Aluminum alloy
2	O-ring	NBR
3	Air guider	POM high viscosity
4	Filter core	Agglomerated by brass grain (GF 34, GF 55, GF 34 A, GF 55 A) Makrolon fiber (5 µm)
5	Umbrella baffle	POM high viscosity
6	Drain bowl	Aluminum alloy (GF 34, GF 55, GF 34 A, GF 55 A) PC (other)
7	Liquid meter cover	Steel
8	Liquid meter seal	FKM
9	Liquid meter inside cover	PC

»G« Series

GF 11–GF 55 A

Accessories

	For GF 11–GF 13 and GF 11 A–GF 13 A	For GF 32, GF 33, GF 32 A and GF 33 A	For GF 34, GF 55, GF 34 A and GF 55 A	Type
	Art. No.	Art. No.	Art. No.	
	GF 11 300	GF 32 300	GF 34 300	Polycarbonate bowl with semi-automatic drain valve for filters/filter regulators
	GF 11 600	GF 32 600	GF 34 600	Polycarbonate bowl with automatic drain valve for filters/filter regulators
	GF 11 500	GF 32 500	–	Protective cage
	GF 11 400	GF 32 400	GF 34 400	Filter element 5 µm
	HW 301	HW 401	HW 601	Mounting bracket, incl. 4 screws
	UB 300	UB 400	UB 600	Joiner without wall mounting
	LB 300	LB 400	LB 600	Joiner with wall mounting, 1 drilled hole
	TB 300	TB 400	TB 600	Joiner with wall mounting, 2 drilled holes

(Pictures are similar to product.)