

Straight check valve

»blue series«

EASY

Art. No. 110236

Type No. 201.184

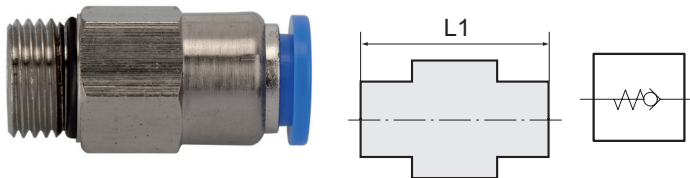

Exemplary illustration

The non-return function of these push-in fittings prevents the air from flowing back, the unidirectional design means air flow is only possible in one direction.

As long as stock lasts. Subject to prior sale.

Due to stock clearing, the items are excluded from return.

The warranty obligation is not affected.

Discontinued product. No longer available. New product 151510 (201.184-2)

Technical data

| | |
|-----------------------|---------------------------------|
| Working pressure | 0 - 10 bar |
| Min. opening pressure | 0.2 bar |
| Temperature range | 0 to 60 °C |
| Series | Blue series |
| Material | Plastic and nickel-plated brass |
| Medium | Compressed air |
| Sealant | NBR |
| Sleeve | Plastic blue |
| Applications | Compressed air systems |
| Recommended hose | PU or PA (nylon) |
| Flow direction | From tube to port |
| Thread form | Parallel male thread |
| Standard thread | DIN EN ISO 228-1 |
| Version | With o-ring (NBR) |
| Thread | G 1/8 |
| For tube O.D. | 4 mm |
| L1 | 24.2 mm |
| a/f | 14 mm |

The suitability test for the use with alternative specifications is the user's responsibility.

Commercial data

| | |
|-------------------------|------------------|
| Customs tariff number | 39174000 |
| Country of origin | CN |
| eCl@ss 5.1.4 | 27292001 |
| eCl@ss 9.0 | 27292001 |
| UNSPSC_Code_v190501 | 40141603 |
| UNSPSC_CodeDesc_v190501 | Pneumatic valves |

Material informations

| | |
|----------------------------|-------------------------|
| REACH SVHC1 substance name | lead |
| CAS no. SVHC 1 | 7439-92-1 |
| RoHS materials notice | RoHS compliant |
| REACH Info | contains SVHC substance |

Dimensions

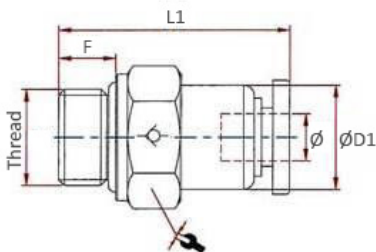

| Thread | Standard thread | For tube O.D. | F | a/f | L1 | D1 |
|--------|------------------|---------------|-----|-----|------|------|
| | | mm | mm | mm | mm | mm |
| G 1/8 | DIN EN ISO 228-1 | 4 | 5.5 | 14 | 24.2 | 10.0 |