

Straight push-in bulkhead connector

stainless steel

STAINLESS STEEL

Art. No. 135261

Type No. 851.026-16 ES

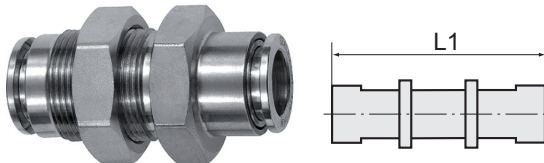

Exemplary illustration

For use in more aggressive environments and corrosive media.
The suitability test for the individual application is the user's responsibility.

Technical data

| | |
|-------------------------|--|
| Working pressure | -0.98 - 20 bar |
| Operating temperature | -20 to 150 °C |
| Medium temperature | -20 to 150 °C |
| Material | Stainless steel 1.4404 |
| Medium | Compressed air, corrosive media (if compatible with material) |
| Sealant | FPM |
| Applications | Compressed air syst., chemical and food, pharma, pack., vacuum |
| Thread | M26x1.5 |
| For tube O.D. | 16 mm |
| L1 | 48.4 mm |
| a/f | 30 mm |
| Suitable pipe materials | PVDF, PTFE, PA, PU |

The suitability test for the use with alternative specifications is the user's responsibility.

Commercial data

| | |
|-------------------------|--------------|
| Customs tariff number | 73072910 |
| Country of origin | IN |
| eCl@ss 5.1.4 | 27294201 |
| eCl@ss 9.0 | 27294201 |
| UNSPSC_Code_v190501 | 27131613 |
| UNSPSC_CodeDesc_v190501 | Air coupling |

Material informations

| | |
|----------------------------|----------------------------|
| REACH SVHC1 substance name | no |
| CAS no. SVHC 1 | no CAS No. |
| RoHS materials notice | RoHS compliant |
| REACH Info | no SVHC substance included |

Dimensions

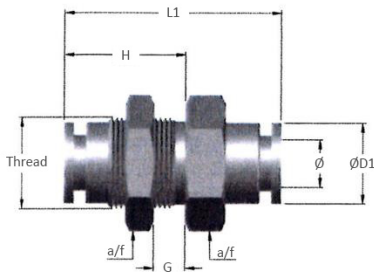

| Thread | For tube O.D. | H | a/f | L1 | D1 | G |
|---------|---------------|------|-----|------|------|------|
| | mm | mm | mm | mm | mm | mm |
| M26x1.5 | 16 | 27.2 | 30 | 48.4 | 23.3 | 10,0 |