

Straight check valve

»blue series«

EASY

Art. No. 151531

Type No. 204.10-2

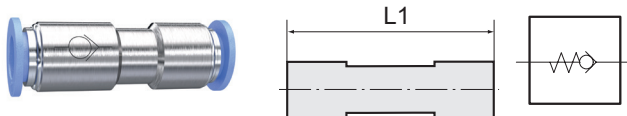

Exemplary illustration

The non-return function of these push-in fittings prevents the air from flowing back, the unidirectional design means air flow is only possible in one direction.

Technical data

| | |
|-----------------------|---------------------------------|
| Working pressure | 0 - 10 bar |
| Min. opening pressure | 0.2 bar |
| Temperature range | 0 to 60 °C |
| Series | Blue series |
| Material | Plastic and nickel-plated brass |
| Medium | Compressed air |
| Sealant | NBR |
| Sleeve | Plastic blue |
| Applications | Compressed air systems |
| Recommended hose | PU or PA (nylon) |
| Version | With plug connection |
| For tube O.D. | 10 mm |
| L1 | 61.5 mm |

The suitability test for the use with alternative specifications is the user's responsibility.

Note on the sealing effect of check valves: The pressure prevailing on the outlet side supports the shut-off components. A minimum pressure of 1.3 bar (hose connection 4-8 mm) and 2 bar (hose connection 10-12 mm) is required to prevent backflow.

Commercial data

| | |
|-------------------------|------------------|
| Customs tariff number | 84813099 |
| Country of origin | CN |
| eCl@ss 5.1.4 | 27292001 |
| eCl@ss 9.0 | 27292001 |
| UNSPSC_Code_v190501 | 40141603 |
| UNSPSC_CodeDesc_v190501 | Pneumatic valves |

Material informations

| | |
|----------------------------|-------------------------|
| REACH SVHC1 substance name | lead |
| CAS no. SVHC 1 | 7439-92-1 |
| RoHS materials notice | RoHS compliant |
| REACH Info | contains SVHC substance |

Dimensions

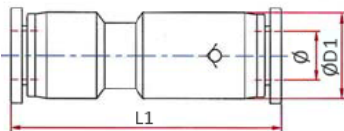

| For tube O.D. | L1 | D1 |
|---------------|------|------|
| mm | mm | mm |
| 10 | 61.5 | 17.0 |

Accessories

| | Art. No. | Type No. |
|---|----------|----------|
| Loosening tool, quick-connect fittings, hose exterior Ø 3 - 10 mm | 108853 | LW3-10 |
| Loosening tool, quick-connect fittings, hose exterior Ø 4-14 mm | 121863 | LW4-14 |